

MIRALOMA LIFE

February 2019 - Issue 6

Upcoming Events

7 FEBRUARY

MPIC Board Meeting*
7:00 pm - MPIC Clubhouse

7 MARCH

MPIC Board Meeting*
7:00 pm - MPIC Clubhouse

TUES + THURS

MP Community Connectors Seniors
10:30 am - Cornerstone
Trinity Baptist Church

WEDNESDAYS

MP Community Connectors Seniors
10:30 am - MPIC Clubhouse

*Members wishing to address the the Board should call (415) 281-0892 to request placement on the agenda

Inside This Issue

Miraloma Park Model from 1938 Golden Gate International Exposition

President's Message

Tidy Up Tips!

How To Become A Crime Stopper

Police Patrols in Miraloma Park

History of Mt. Davidson - Part I

Jacquie Proctor

Don Jose de Jesus Noe was the first owner of what we now call Mt. Davidson Park when it was part of a 4,443-acre land grant by Mexican Governor Pio Pico in 1845. After California's statehood in 1850, Noe's cattle grazing Rancho San Miguel changed ownership several times, but the City's highest hill remained relatively unchanged until German immigrant, Adolph Sutro, stopped mining the original Mt. Davidson in Nevada. Solving the ventilation and drainage problems with a five-mile tunnel into the silver-rich Comstock Lode made Sutro and his partners multi-millionaires. One of his first investments in 1881 was 1400 acres of Rancho San Miguel.

At the urging of the poet, Joaquin Miller (one of the first to promote preservation of the Sierra Nevada forests), Sutro gave school children and the unemployed tree seedlings to plant on his land in celebration of the first Arbor Days. Sutro believed that the planting of trees and hiking in the forests they created would improve the mental and physical health of his fellow residents.

(The east side of the park is treeless because it was owned by Leland Stanford). Sutro willed his original 1,400 acres (including the western slope of Mt. Davidson) to an educational trust so his forest land would be preserved for public recreation, but some of his heirs convinced the California Supreme Court to invalidate the will. They sold 700 acres to housing developer, A.S. Baldwin, for \$1.4 million in 1911. Baldwin funded the building of a hiking trail to the top of "his" forested side of Mt. Davidson "for the pleasure of the public," as part of his development advertisement plan.

Over a decade later, however, the San Francisco Chronicle proclaimed "Mt. Davidson Unknown to S.F. Citizens." The hilltop's obscurity would change after Western Union official James Decatur took up that hiking invitation in 1923 and wrote about the experience: "As the group found themselves deeper in the wood ... peace and quiet were so profound that it seemed almost unbelievable that the noise and roar of a great city was only a few minutes behind them ... The solitude of the forest ... conveyed a sense of vastness quite as real as one would experience among the age-old monarchs of the High Sierras ... The undergrowth

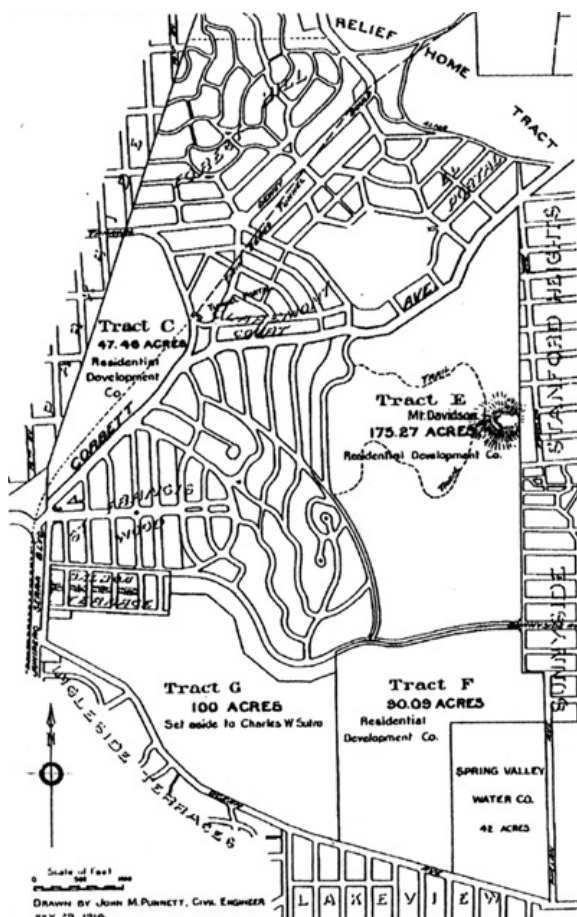

A.S. Baldwin 1924 Subdivision Plan and Trail for Sutro's Property

[continued on page 2]

[continued from cover]

History of Mt. Davidson ...

and flowers looked as if they might have been there for centuries ... Decatur got Baldwin's permission to organize an Easter Sunrise Ceremony atop Mt. Davidson on April 1, 1923. With over 5000 hiking there before dawn to hear the dean of Grace Cathedral, Decatur and Baldwin decided to make it an annual event.



Madie Brown

Attending the ceremony three years later, Mrs. Edmund N. "Madie" Brown, was also inspired - but for a different reason. She wanted to put a stop to "the subdivider's axe and steam shovel from destroying in ruthless fashion the beauties of nature on our beloved Mt. Davidson." The Federation of Women's Clubs joined forces with her "to preserve for San Francisco this wooded hill, Mt. Davidson, which will serve to provide our school

children with the environment for nature study, the Boy Scouts with an outdoor playground for hikes and overnight camping, the Easter pilgrim with a place of worship on its summit at dawn, and the visitor with unsurpassed views from the highest point in the city." Prominent citizens were interviewed, letters were written to individuals and organizations asking for their support, and publicity was secured through press and movie newsreels.

An editorial in the April 26, 1927 San Francisco Examiner supported City purchase of the land: "As the residential area advances, the forest goes down before the axe. In another year, it will be too late for the beauty of the summit to be preserved ..." Three days later, a report to the Finance Committee of the Board of Supervisors recommended purchase of the summit of Mount Davidson "for a public park serving the needs of the West of Twin Peaks District and also serving as a recreation center and forest playground for the whole city. The acquisition will also preserve for all time the beautiful tree covered slopes of the mountain as an attractive scenic land mark in the city ..."

The sum of \$15,000 was approved to purchase the first 20 acres in 1927 with the support of Mayor Rolph and the first woman elected to the Board of Supervisors, Margaret M. Morgan. The park was dedicated on the 84th birthday of Park Superintendent John McLaren in 1929 with a plaque honoring Madie Brown: "who found beauty in flower and

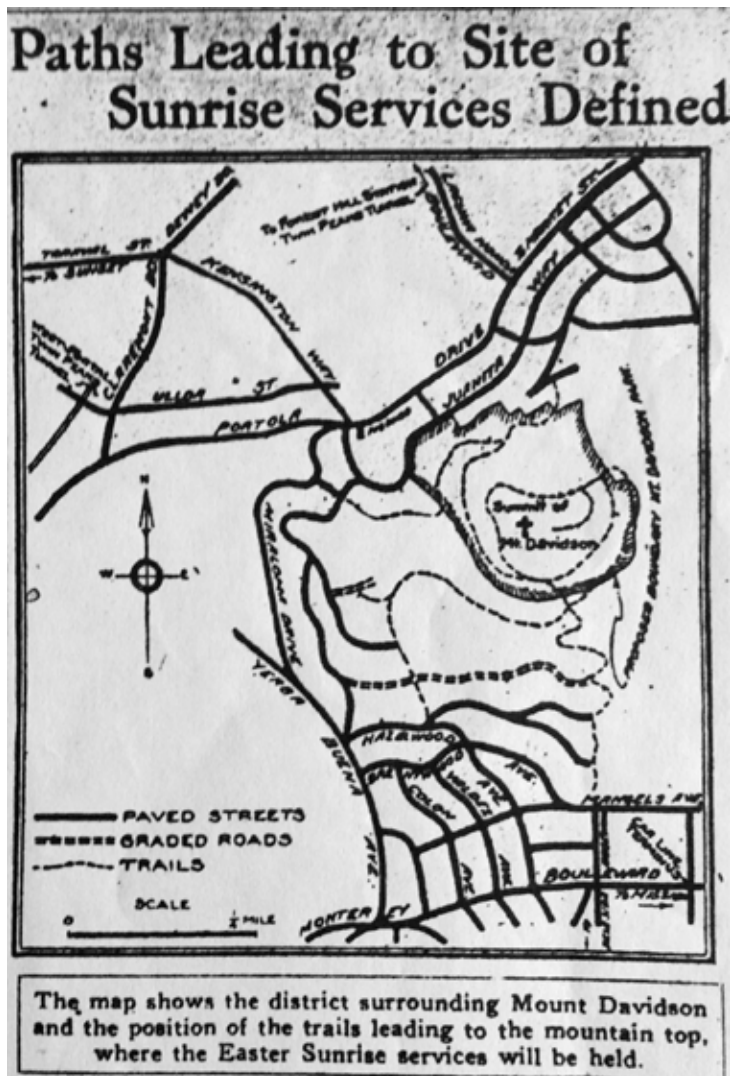

1929 Proposed Mt. Davidson Park Boundary

tree on this lofty hill. Through her untiring pleas, these acres have been set aside as a city park that all may enjoy their beauty and find refreshment of the soul." But that's not the end of the story ... **Stay tuned for Part 2 in next month's Miraloma Life!**



We've updated our Miraloma Park Boundaries Map!

We updated our Miraloma Park Boundaries Map on the website using a new Google Map. The advantage of the Google Map is that you can zoom in and study the exact edges of the boundaries in finer detail. Check it out at <https://miralomapark.org/neighborhood/location/>

President's Message

Joanie van Rijn

Kung Hei Fat Choi, Gongxi facai! Happy New Year! It's going to be the Year of the Pig and MPIC wishes all families a healthy and prosperous New Year. Please remember it is against the law to set off any kind of firecracker or fireworks. I know it is tradition but please help protect our neighborhood and not use firecrackers.



At the January MPIC Board meeting Suzanne Gautier (inset) from the Public Utilities Commission gave us some good news. The Stanford Heights Reservoir, at Agua Way and Teresita, will have a full-time gardener to keep up the landscaping.

Suzanne was asked about the return of the goats and she was unsure when that would occur again. We thank Mike Naughton who brought the need for better maintenance at the reservoir to our attention.

MPIC supported new Participatory Budgeting Projects and these have been reviewed by the Neighborhood Council, a group of neighbors from all across our District 7. We thank Jean Perata for being our representative. The next step is our projects will be reviewed by city departments for feasibility and then Board President Yee's office will prepare a ballot of projects to vote on. Stay tuned we will all need to vote in March. Anyone who lives, works, plays, or prays

in our neighborhood will be able to vote. We count on your votes to get these grant projects funded.

Congratulations to our District 7 Supervisor, Norman Yee. He was elected President of the Board of Supervisors. We wish Board President Yee an auspicious year and we look forward to his leadership in providing our neighborhood services that we need.

It's not too late to become a member of MPIC and renew your membership. Go to the website miralomapark.org and hit the button JOIN! We thank all of you who have been sending in your envelopes. Your dues are critical. It is the only way we fund maintenance at the club house, have Senior Programming, and print our monthly newsletter.

The MPIC Board is exploring ways we can generate more income to keep our club house well maintained. It is an historic building, circa 1939, and needs lots of tender loving care, it's also expensive. We need to replace the roof, it has a small leak. We have patched the roof but the source of the leak is still unknown. The building will also need to be painted in the near future.

Miraloma Park is made up of friends, families, people like you and me. We all want our neighborhood to be a safe, prepared community. Join with others and become a member of the Miraloma Park Improvement Club, we help connect people, take action and make this the best neighborhood in San Francisco.



BECOME AN MPIC MEMBER OR RENEW YOUR MEMBERSHIP!

ONLINE AT:

<https://miralomapark.org/join>

OR BY MAIL:

Complete this form and mail with your dues, check payable to:

MIRALOMA PARK IMPROVEMENT CLUB, 350 O'SHAUGHNESSY BLVD, SF, CA 94127. No cash, please.

MPIC does not share membership information with other parties or organizations.

☐ NEW MEMBER ☐ RENEWING MEMBER Date: _____

Name: _____

Address: _____

Phone: _____ Email: _____

Enclosed are my dues for the next 12 months (check one):

☐ \$12 Senior Member ☐ \$15 Single Member ☐ \$25 Family Membership
☐ \$35 Supporting Member ☐ \$50 Contributing Member ☐ \$100 Sustaining Member
☐ \$ _____ Other

☐ PLEASE SEND ME AN EMAIL REMINDER TO RENEW MY MEMBERSHIP!

See the Model of Miraloma Park in 1938!

Learn about Miraloma Park's History

Jean Perata



1938 Model of Miraloma Park

Today we have Google Maps, but in earlier years we had models and maps. From February 1 through March, 2019 you can see the 1938, three-dimensional model of Miraloma Park and adjacent areas at the Glen Park Public Library, 2825 Diamond Street. Visit the Library on February 21 from 6pm to 7pm for a presentation about the model. Join Glen Park historian Evelyn Rose, Mt. Davidson historian Jacquie Proctor, Sunnyside historian Amy O'Hair, and Diamond Heights architectural historian Hannah Simonson as they use the pieces of the City model and 1938 aerial views of San Francisco to help describe the history of development in our area.

Display of the model and the February 21 event are part of Take Part, an exhibition sponsored by the San Francisco Museum of Modern Art and the San Francisco Public Library. Take Part was conceived by Dutch artist Bik Van der Pol in collaboration with over a hundred local librarians, historians, geographers, cartographers, urban planners, artists and designers.

How did the 3-d model come to be?

In April 1940, the Federal Works Project Administration (WPA) presented a 41-foot by 37-foot, three-dimensional scale model of San Francisco to Mayor Angelo Rossi.

The model had been commissioned by the City Planning Commission; the intent of the model was to allow the study of "graphic illustrations of proposed zoning changes in all districts of the City."

The mostly-wood model is in a scale of one inch to 100 hundred feet. It depicts every structure standing in the City at the time. Parks, lakes, theatres, schools, and even the color schemes of individual houses are accurately represented. Assembled like a jigsaw puzzle, each of the 138 sections of the model can be removed for closer inspection. The project took 1,200 hours to complete and cost nearly \$103,000 (\$1.8 million today). Today, the model provides a fascinating historical view of San Francisco in the late 1930's. Two sections of the model will be on view at the Glen Park Library.

Where has the model been?

The San Francisco City Model was first displayed in sections at the Golden Gate International Exposition on Treasure Island in 1939. From 1940 to 1942, it was displayed in City Hall. The model has not been on public view in its entirety since 1942. It has been in storage for over a half-century.



(top) Poster for the Golden Gate International Exposition; (bottom) Dutch Artists Bik Van de Pol



TAKE PART

Sections of the San Francisco City Model are being exhibited at branches of the San Francisco Public Library through March 25, 2019. Each neighborhood is on display in its corresponding library, including the 27 neighborhood branches, the main branch, and the temporary branch at SFMOMA.

Events and programs have been developed according to each neighborhood's interests and focus on key themes, broadly related to publicness and civic participation.

For more information on the City-wide event visit:

<https://publicknowledge.sfmoma.org/take-part> and <https://sfpl.org/take-part>



Section cut of the model showing the center of San Francisco



www.kuhnline.com

Complete computer support for your home or business

Based in Miraloma Park
Available for Housecalls
Over 15 Years Experience
Free Estimates

Phone 415-244-0701
helpdesk@kuhnline.com

- virus cleanup | backups | data recovery | WiFi networks | new computer advice / setup | email | mobile devices | desktops | laptops | Windows | Mac



MIRALOMA PARK COMMUNITY CONNECTORS SENIOR PROGRAM

We're changing strangers into neighbors and neighbors into friends. All Miraloma neighbors over 60 are invited to join us for strength, flexibility and balance exercises.

**Always Active Exercise Every Tuesday,
Wednesday and Thursday**

10:30 am to 11:30 am

**Tue & Thur at Cornerstone Church
Wed at MPIC Clubhouse**

For more information contact:

Darlene Ramlose, Miraloma Community Connector

darlene@sfcommunityliving.org or

714-423-8844.

Visit us on our Facebook page:

Miraloma Park Community Connectors.

**COME LEARN IN A
SAFE, CONFIDENTIAL AND
SUPPORTIVE ENVIRONMENT**

Miraloma Community Connectors Upcoming Events

Darlene Ramlose

Along with our weekly Always Active Exercise Classes at the MPIC Clubhouse and Cornerstone Church, come join us at these wonderful events!

February 6, 13, 20, 27 and March 6, 2019

Noon to 2:00pm at MPIC Clubhouse

6-Week Diabetes Program

Healthy Living with the DEEP Program. An interactive class to help those living with diabetes live a healthy lifestyle.

February 14 - 11: 45am at Cornerstone Church

Valentines Day Party and Craft

Bring a photo, make a card for someone special.

February 28 - 11: 45am at Cornerstone Church

The History of Miraloma Park by Chris Carlsson

March 7 & 14, 2019, 11:45 am at Cornerstone Church

Gaining Through Loss - Come and join Cayuga Community Connectors with Poet/Writer Julie Rogers conducting a two-part workshop emphasizing memoir-oriented writing directed inward using free association and sensory prompts, works with unspoken or unfinished stories and the potential to expand views on grief and healing. The series will include writing exercises to discover what is revealed by the six sensory experiences.

March 21, 2019, 11:45 am at Cornerstone Church

California's End of Life Option Act (EOLA) - Rufus Browning discusses the EOLA which became effective on June 9, 2016. The Act allows terminally ill adults living in California to obtain and self-administer aid-in-dying drugs. Join us for an engaging talk and Q&A where Rufus will speak about his late brother Charles.

LANTERN CHECK!

Let's be prepared!

If you attended the Senior Earthquake Preparedness Workshop last year at the MPIC Clubhouse and were given one of these LED lanterns, it is time to test the lantern to see if it still works.

If you would like your lantern to be checked to see if the batteries are leaking, please bring your lantern and 6 new DD batteries to Community

Connectors on any Tuesday or **Thursday at Cornerstone Trinity Baptist Church at 11:30am** and someone will help you.



Are You "Tidying Up?"

By Catherine Homsey

It seems like everyone is watching the Netflix series, "**Tidying Up with Marie Kondo**." If you're one of them, you've probably begun the process of "tidying" your home.

Ms. Kondo is a true cultural phenomenon. Her book was a best seller around the world. A wave of people who began using her methods to tidy and organize, myself included! Although I had already been reducing clutter and waste, Kondo's quirky yet effective methods taught me to take things to the next level. It's no wonder she has such a huge following!

Now, with the series, even more people are jumping on the bandwagon. It's fantastic to release the items that are no longer serving a purpose in your life, isn't it? ***But what do you do with that mountain of stuff you're discarding?***

Below are some tools and resources for you to use to decide where and how to dispose of things that don't "spark joy."

Let's start by going back to the 5 R's of Zero Waste: Refuse, Reduce, Reuse, Recycle & Rot.

Refuse

Refuse isn't going to help us much because we're dealing with stuff we already have. "Reduce" is what you are doing now by discarding unwanted items. However, we can use the remaining three R's.

Reuse

If the items are in good condition, they can be reused by someone. In this case, donation is the best option. Clothes, books, toys, housewares, tools, décor, furniture, etc. are all

donatable if they are in good shape. Good places to donate are:

- General (clothing, toys, books, furniture, housewares, electronics): Goodwill, Community Thrift, Salvation Army
- Arts & Crafts, Office Supplies: SCRAP SF
- Clothing: Out of the Closet, Casa de las Madres, Homeless Prenatal Program, St. Anthony Foundation

Be sure to check the organizations' websites before donating to ensure they can accept your items.

If the item is not in reusable condition, move to the next R:

Recycle

- Clothing: Recycling clothing and textiles in SF is easy! Just put your clothes and other textiles in a clear bag, tie it off and put it in your blue bin.
- Books: If the books are paper and cardboard, they can go straight into the blue bin (recycling). If they are mixed materials, like laminate, foil, etc. that part of the book goes in the black bin (landfill).
- Paper: This can go in the recycling bin. However, receipts, mix material paper (like laminated and

[continued on page 8]

[continued from page 7]

Are You Tidying Up?

embossed items) go in the black bin. Credit cards can go in recycling. If you have paper that needs to be shredded, either shred it yourself or take it to a place like Office Max where they charge by the pound. If you shred it at home, put it in a paper bag and staple it shut, then put it in the compost bin. (Shredded paper gums up the recycling sorters.)

- Appliances and Electronics: Schedule a pick up from Recology if you have a large number of appliances or electronics to recycle. If you only have a few boxes, Best Buy takes electronics (including cables, etc.) for recycling. Goodwill will also take some electronics for recycling and refurbishing.

If you're not sure whether something is recyclable, check out the www.recyclewhere.org website or Recology's

What Bin tool: www.recology.com/recology-san-francisco/what-bin/

The final R is: **Rot**

This applies to anything that can't be Reused or Recycled but is compostable. Included in this category is food, food soiled paper, natural herbal supplements, beeswax or soy wax, dirt, plants or cuttings, natural corks, etc. Check the label on your green bin or Recology's website if you aren't sure whether something is compostable.

There will be some things you're discarding that can't be Reused, Recycled, or Rotted (composted.) That's ok. Just dispose of them responsibly. Most things can go straight into the black bin. Some things like batteries, chemicals and electronics cannot. They will leak hazardous chemicals into the soil and ground water if they go into the landfill. Here is what to do:

- Batteries: Put old batteries in a bag on top of your black bin.
- Electronics, Appliances, Furniture: Take it to the Recology disposal center or call Recology for a special pick up. Information is on their website. www.recology.com/recology-san-francisco/
- Chemicals, Paint: Take them to the Recology disposal center or call Recology for a Hazardous Waste pick up.
- Medications: Check the recyclewhere.org website for drop off locations. Police stations and drugstores around the city have disposal bins for medication. I take my clients' old medications to the CVS on Portola. This applies to medicine only. Herbal supplements can go in the compost.
- Dishes, Pottery: These go in the black bin.

I hope this guide is helpful and wish you joy in your tidying endeavors!

For more tips and ideas, follow me on Instagram @joyofzerowaste or check out my website www.joyofzerowaste.com

SUE KIRKHAM REALTOR

CA License #00898385

www.suekirkham.com

**For Miraloma Park
Home Sellers Seeking:**

Highest Sale Prices
Seller Only Representation
State-of-the-Art Marketing Plan + Tools
Expert Preparation + Negotiation Skills
Honesty, Integrity and Good Judgement
Attention to Detail
Full Time Realtor in SF, Since 1985
Neighborhood Knowledge + More!



GLOBAL
LUXURY

PUTTING YOUR INTERESTS FIRST

(415) 706-2668 cell | (415) 333-9840 home office

info@suekirkham.com

www.SueKirkham.com for selling guide, resources + more
CALL OR EMAIL FOR A FREE EVALUATION OF YOUR HOME

MIRALOMA HOME REPORT

No. of Homes Sold	58	Average sf	1,635 sf
Average Sales Price	\$1,557,617	Average Days on Market	20
Median Sales Price	\$1,537,500	Average Sales Price > List	0.23%
Highest Sales Price	\$2,400,000	Sold < List Price	2
Lowest Sales Price	\$1,050,000	Sold > List Price	56
Average Price per sf	\$1,007.86	Withdrawn Listings	1

Financial Planning

Investment Advisory



*Independent Financial Advice from CFA Charterholder
with Over 20 Years Experience, Based in Miraloma Park.*

Education Saving

Retirement Income

(415) 742-1681

bill.kan@candentcap.com

Want to combat crime? Have some spare time?

By the MPIC Safety Committee



Join Stop SF Crime's Court Watch program! Prosecuting attorneys are more likely to bring burglary cases to trial if they know community members are concerned enough about the crime to show up for the proceedings. Prosecutors need our support because they are often alone in the courtroom. Victims can be afraid to attend and it's rare for general members of the community to show up and demand justice. An important part of Court Watch is being there as an advocate for victims to help them feel supported and heard.

And, Court Watch volunteers show judges that the community wants to see cases move forward. The hope is that the courts will be less likely to let burglars off with slaps on the wrist. Judges have told Stop SF Crime that court watchers can have an impact. The people elect judges, after all.

In the Court Watch program, community volunteers attend open court to monitor the trials of defendants charged with burglaries in San Francisco neighborhoods. When you sign up to be a Court Watch volunteer, you will get regular emails that list upcoming cases. You can choose which cases you would like to attend. After your court session, you report what happened with Stop SF Crime's online form. Stop SF Crime compiles the data and post the results so the public can see how judges are doing.

For more information, visit:

<https://stopcrimesf.com/court-watch>

Cassandra Mettling-Davis, Architect
415 664 3400

Kitchens, Bathrooms, Complete Remodels and Additions
CMDarchitecture.com 801 Portola Dr Suite 104 SF CA 94127

CMD Architecture | San Francisco



MPIC President
Joan Van Rijn



Congratulations to Our NEN Award Winners!

The City's Neighborhood Empowerment Network has announced the 11th Annual NEN Awards Winners. The NEN Awards are San Francisco's way of honoring the work of the residents and organizations that make our City an amazing place to live, work and visit.

Congratulations to MPIC President Joan Van Rijn who is this year's winner in the category of Exemplary NERT Leadership and to Capt. Jack Hart, SFPD Ingleside Station in the category of Most Empowering City Employee of the Year.

Thank you for all you do for our community!



MPIC Safety Committee Report

Police Patrols in Miraloma Park

Did you ever wonder just how many police cars are assigned to regularly patrol in Miraloma Park? It's not a simple answer. Miraloma Park is part of the Ingleside Station Police District. The map below shows just how large of an area that the Ingleside Station which is located at Balboa Park, has to cover. The Ingleside Station breaks up the district into 6 distinct sectors with each sector generally staffed by one or more patrol cars during the day, swing and night shifts. Miraloma Park is part of the No. 4 sector which is outlined with the dotted lines on the upper left part of the map. The No. 4 sector boundaries are roughly Portola Blvd at the north, O'Shaughnessy Blvd all the way down to San Jose Avenue and Mission Street at the east, Ocean Avenue at the south and Faxon Avenue and Miraloma Drive at the west.

The No. 4 sector is generally staffed by one patrol car during each shift. During shift changes, you can have two patrol cars in the sector at one time. But due to many reasons such as staffing and many other calls for service throughout the district, the No. 4 sector may end up not having a dedicated patrol car during a shift. However, patrol cars from any of the other 5 sectors would then be assigned to patrol our sector during that shift. In addition, with the Starbucks up on Portola, there is a constant stream of patrol cars always traveling along Teresita Blvd. Most importantly, in the case of a 911 call, any patrol cars in the vicinity, whether they are part of the Ingleside Police Station or Taraval Police Station or other, would respond to the call.

The MPIC has always advocated with the different police captains for staffing a patrol car for the No. 4 sector during each shift. And we will continue to do so. We have a great relationship with Capt. Jack Hart. In the past, the



MPIC has advocated with the Police Commission and the Board of Supervisors to adequately fund the police. Capt. Hart states: "There are some serious challenges covering Tower Market in Miraloma Park to Piccolo Pete's and from St. Luke's to Daly City with the staffing that we have. Not only is the terrain vast but the work itself coupled with all of the oversight measures (documentation, body worn camera, etc.) adds a level of complexity not contemplated by minimum department staffing in the City charter."

The reality is that there are not enough officers to regularly patrol every street in Miraloma Park 24 hours a day, 7 days a week let alone having many patrol cars spend a lot of time patrolling around Miraloma Park. In case of a 911 call, police will respond regardless of which station they are from and which sector they are patrolling.

It's extremely rare when there is a situation where a police officer happens to drive by at that exact time on that street observing a crime in progress. That's why it's important to have neighbors always watching out for each other and to call the police immediately when they see suspicious activity. It's also important to report all crimes including auto break-ins and package thefts so that trends can be determined. Based on those trends, we can ask the police to make passing calls on certain streets at certain times of the day when there is a higher probability of certain crimes.

SFPD Incident Reports:

December 12, 2018 – January 9, 2019

DATE	TIME	ADDRESS	DESCRIPTION
12-14-2018	16:00	Rockdale Dr\Omar Way	Larceny Theft >\$950
12-21-2018	20:05	Teresita Blvd\Foerster	Theft from Vehicle >\$950
12-27-2018	18:30	Myra Way\Reposa Way	Motor Vehicle Theft
12-28-2018	8:17	Melrose Ave\Standford Heights Ave	Violation of Restraining Order and Vandalism
12-28-2018	23:44	Woodside Ave\O'Shaughnessy\Portola	Traffic Violation Arrest, Driving w/out License and Traffic Collision
12-29-2018	23:36	Avoca Alley\Block Bella Vista Way	Hot Prowl Burglary
Ingleside officers responded to a burglary in progress. Officers arrived on scene and the victim told them that she and her husband heard noises coming from downstairs. The officers searched the residence for suspects yielding negative results. The victim reported hearing noises consistent with her door knob being manipulated and also footsteps. The victim never saw a suspect and yelled out to leave, because she was calling the police. The victim believes that the suspects gained entry through an exterior garage door which was found slightly ajar by officers on scene. The victim was not injured during this incident.			
12-30-2018	23:00	Teresita \Marietta	Theft from Vehicle >\$950
12-31-2018	9:00	Teresita at Reposa	
A young man parked his truck and starting walking around in the middle of the street harrassing passerbys. The man seemed very disturbed. Five police officers responded and handled the situation very professionally and subdued the individual with a minimum of force.			
1/2/2019	15:00	700 Block Portola Ave	Theft
Ingleside Officer Peralta responded to the CVC store on the report of a theft from a store. The suspects had fled in a vehicle prior to officers arriving on scene. The employee reported that he confronted a male subject for stealing inside of the store. The suspect became irate and pushed through a security guard to exit the store with his bag full of stolen items. No one was injured during this incident.			
1/2/2019	10:30	Rockdale Dr\Isola Way	Burglary
1/3/2019	18:30	Teresita Blvd\Reposa Way	Burglary

Get Connected.

Text your ZIP CODE to 888-777 to receive real time emergency alerts.

AlertSF is a service managed by the City and County of San Francisco department of Emergency Management.

For more info, visit www.alertsf.org

MELINDA ATTAR

Cleaning Service

Serving the Community Since 1986

Local References Available **(415) 640-2839**

CARLOS CARPET, LINOLEUM & HARDWOOD SERVICE

Residential • Commercial • Sales • Repairs

FREE ESTIMATES

National Brand Names
Karastan, Wool, Armstrong
Shaw, Mohawk, Coronet
Many colors in stock

Carlos Rios
415-533-3697
600 Rockdale Dr.
San Francisco, CA 94127

Pop's Sandwich Shop

Premium Toasted Sandwiches in YOUR Neighborhood

737 PORTOLA DRIVE, SF, CA 94127

Maria Kakos Spiegel
Mont Blanc Pizzerias, Inc.
737 Portola Drive, SF, CA 94127
415-681-9501 loukoume@aol.com



GOOD TO KNOW: MIRALOMA PARK RESIDENTIAL GUIDELINES



Adopted in 1999 by the SF Planning Commission to promote preservation of our neighborhoods character by encouraging residential design that elevates and is compatible with our neighborhood setting. The Guidelines facilitate the process of permit application and code-mandated design review and could prevent costly, time-consuming Discretionary Review proceedings.

Learn more: www.miralomapark.org/neighborhood/design-guidelines

Important Numbers

EMERGENCY LAND LINE	911
EMERGENCY MOBILE PHONE	(415) 553-8090
Suicide Prevention Hotline	(415) 781-0500
Poison Control Center	(800) 222-1222
Non-Emergency Police Dispatch	(415) 553-0123
Ingleside Police Community Room	(415) 404-4000
Anonymous Tip Line - Ingleside Police	(415) 587-8984
Anonymous Narcotics Tip Line	(800) CRACKIT
Domestic Family Violence (24hrs)	(800) 799-SAFE
Animal Cruelty, Distress, Injury	(415) 554-9400
Office of Citizen Complaints Against SFPD	(415) 241-7711 https://policecomplaints.sfgov.org/
San Francisco City Services (abandoned vehicles to graffiti clean-up to Muni issues + more)	311 https://sf311.org/
PG+E Call Before You Dig	811
SF Building Dept Code Enforcement Hotline	(415) 575-6863 Planning.CodeEnforcement@sfgov.org
Norman Yee, District 7 Supervisor	(415) 554-6516 norman.yee@sfgov.org
Mayor's Office of Neighborhood Services	(415) 554-7111



MPIC Board of Directors

President	Joanie van Rijn
Vice President	Jean Perata
Recording Secretary	Reza Vagefi
Corresponding Secretary	Vacant
Treasurer	Robert Gee
Sergeant-at-arms	Vacant
Karen Breslin	Debra Estrin
Bryan Forman	Robert Gee
Daniel Homsey	Thomas O'Brien
Jean Perata	Darlene Ramlose
Todd Siemers	Reza Vagefi
Joanie van Rijn	

MPIC Directory

www.miralomapark.org

General Inquires for MPIC	(415) 281-0892
Clubhouse Manager + Rentals	(415) 281-0892
Webmaster: Ron Proctor	(415) 281-0892
Miraloma Elementary School	(415) 469-4734
Miraloma Co-op Nursery School	(415) 585-6789
Miraloma Playground	(415) 337-4704

Miraloma Life Staff

Contact: miralomapark@gmail.com
(415) 281-0892

Editor	Robert Gee
Advertising	Daniel Homsey
Graphics/Layout	Sarah Mergy

Article Submission Policy:

Email submissions to: miralomapark@gmail.com with **Miraloma Life** in the subject line. Articles submitted must be 800 words or less in length and should not be selling or promoting a product or service. Anonymous submissions will not be considered for publication.

Deadline for submissions is February 12, 2019

Submitted articles become the property of MPIC.